



Neutral conductor, leading switching for Front mounting, Up to 32 A., Accessory for main and emergency stop switch 3LD2

| Model | |
|--|---|
| product brand name | SETRON |
| product designation | Neutral conductor |
| design of the product | accessories for 3LD2 main and EMERGENCY-STOP switches |
| Accessories | |
| accessories | leading switching for front mounting, up to 32 A, |
| AWG number as coded connectable conductor cross section | |
| • minimum | 14 |
| • maximum | 8 |
| type of connectable conductor cross-sections for main contacts | |
| • finely stranded with core end processing | 1x (1.5 ... 16 mm ²) |
| • solid or stranded | 1x (1.5...10 mm ²) |
| Mechanical Design | |
| Net Weight | 37 g |
| Approvals Certificates | |
| General Product Approval | other |



[Confirmation](#)

Environment

[Environmental Conformations](#)

[Environmental Conformations](#)

Further information

Information on the packaging

<https://support.industry.siemens.com/cs/ww/en/view/109813875>

Information for data generation and storage

<https://support.industry.siemens.com/cs/ww/en/view/109995012>

Information- and Downloadcenter (Catalogs, Brochures,...)

<http://www.siemens.com/lowvoltage/catalogs>

Industry Mall (Online ordering system)

<https://mall.industry.siemens.com/mall/en/en/Catalog/product?mlfb=3LD9220-0B>

Service&Support (Manuals, Certificates, Characteristics, FAQs,...)

<https://support.industry.siemens.com/cs/ww/en/ps/3LD9220-0B>

Image database (product images, 2D dimension drawings, 3D models, device circuit diagrams, ...)

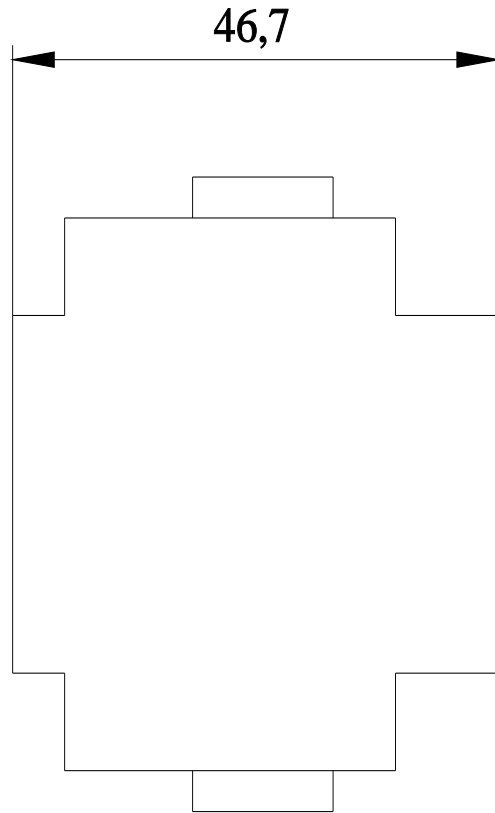
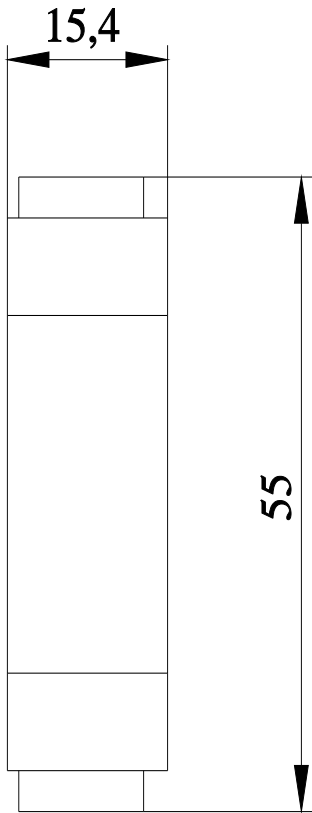

last modified:

4/12/2025 

