

Current transformer 20...200 A for 3RB22/23/24 Size S6 Contactor mounting/stand-alone installation Main circuit: straight-through transformer Auxiliary circuit: --



product brand name	SIRIUS
product designation	Current measuring module
product type designation	3RB29
General technical data	
Substance Prohibition (Date)	07/01/2006
SVHC substance name	Lead monoxide (lead oxide) - 1317-36-8
Weight	0.655 kg
Main circuit	
adjustable current response value current of the current-dependent overload release	20 ... 200 A
operating voltage	
• at AC-3e rated value maximum	1 000 V
operational current rated value	200 A
operational current at AC-3e at 400 V rated value	200 A
Installation/ mounting/ dimensions	
fastening method	Contacting mounting/stand-alone installation
Connections/ Terminals	
type of electrical connection	
• for main current circuit	straight-through transformers
Electrical Safety	
protection class IP on the front according to IEC 60529	IP20
touch protection on the front according to IEC 60529	finger-safe, for vertical contact from the front
Approvals Certificates	
General Product Approval	For use in hazardous locations



For use in hazardous locations

Test Certificates

Maritime application

[Miscellaneous](#)

[Special Test Certificate](#)

[Type Test Certificates/Test Report](#)



Maritime application

other

Environment

Further information

Information on the packaging

<https://support.industry.siemens.com/cs/ww/en/view/109813875>

Information for data generation and storage

<https://support.industry.siemens.com/cs/ww/en/view/109995012>

Information- and Downloadcenter (Catalogs, Brochures,...)

<https://www.siemens.com/ic10>

Industry Mall (Online ordering system)

<https://mall.industry.siemens.com/mall/en/en/Catalog/product?mlfb=3RB2956-2TG2>

Cax online generator

<https://support.automation.siemens.com/WW/CAXorder/default.aspx?lang=en&mlfb=3RB2956-2TG2>

Service&Support (Manuals, Certificates, Characteristics, FAQs,...)

<https://support.industry.siemens.com/cs/ww/en/ps/3RB2956-2TG2>

Image database (product images, 2D dimension drawings, 3D models, device circuit diagrams, EPLAN macros, ...)

https://www.automation.siemens.com/bilddb/cax_de.aspx?mlfb=3RB2956-2TG2&lang=en

Characteristic: Tripping characteristics, I²t, Let-through current

<https://support.industry.siemens.com/cs/ww/en/ps/3RB2956-2TG2/char>

Further characteristics (e.g. electrical endurance, switching frequency)

<https://www.automation.siemens.com/bilddb/index.aspx?view=Search&mlfb=3RB2956-2TG2&objecttype=14&gridview=view1>

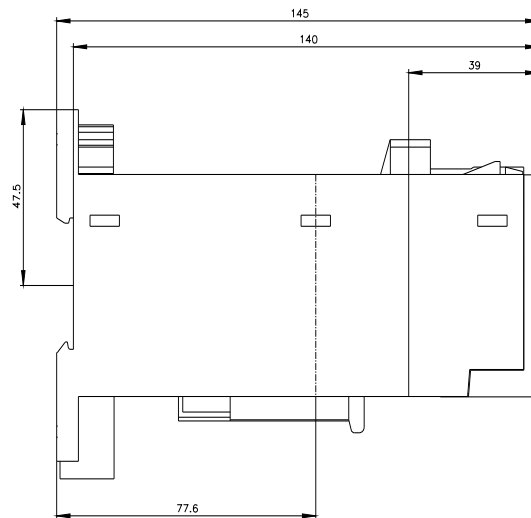
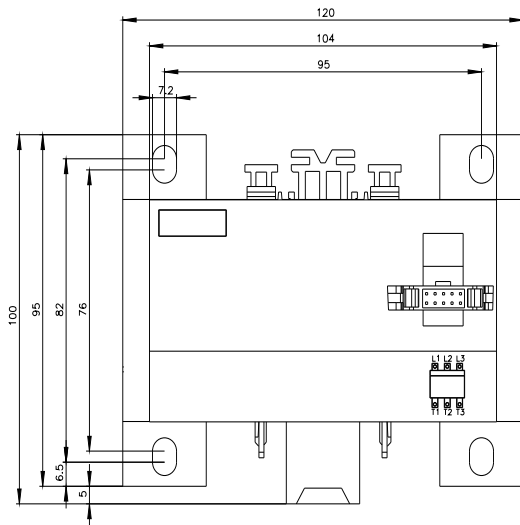

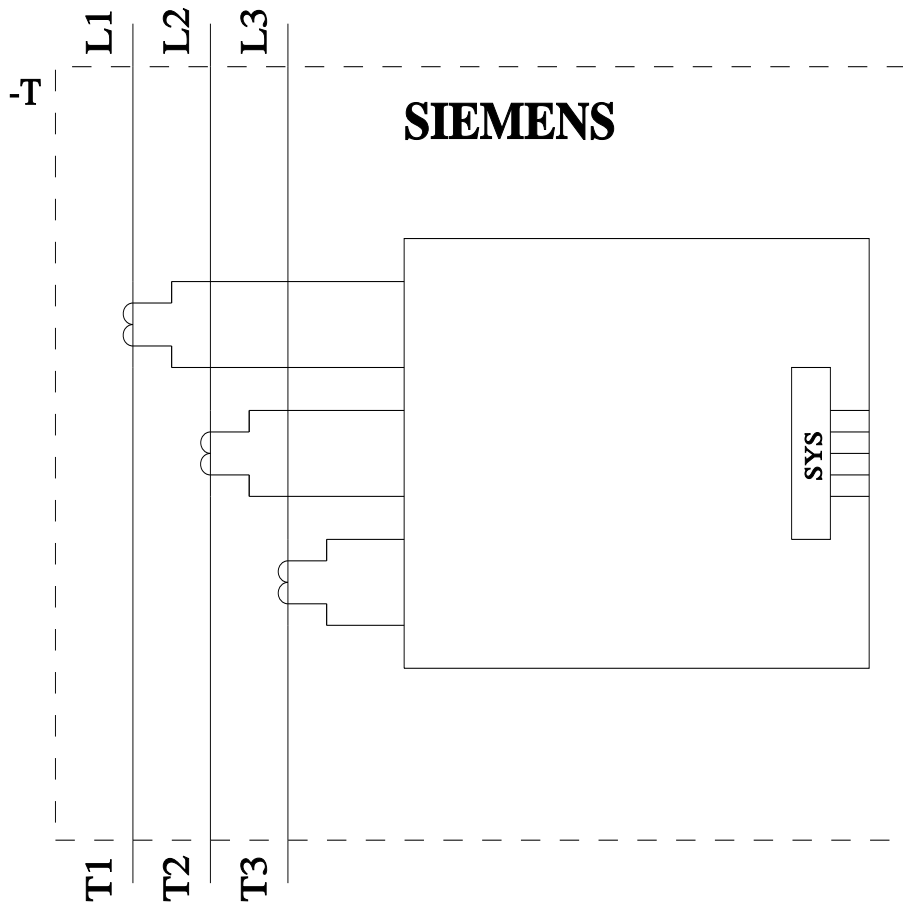

last modified:

4/2/2025 