



Push-in lug size S00/S0

product brand name	SIRIUS
product category	Push-in lugs
product designation	Push-in lugs
design of the product	Can be used for 3UF71.0, 3UF71.1 and 3UF71.2
product type designation	3RV29

General technical data

certificate of suitability	CE / UL / CSA / CCC
Substance Prohibitance (Date)	10/01/2009
Weight	0.002 kg

Ambient conditions

ambient temperature	
<ul style="list-style-type: none"> during operation during storage 	<p>-20 ... +70 °C</p> <p>-50 ... +80 °C</p>

Installation/ mounting/ dimensions

fastening method	clip-on
height	27 mm
width	10 mm
depth	4.7 mm

Approvals Certificates

General Product Approval	Test Certificates	Maritime application
--------------------------	-------------------	----------------------



[Type Test Certificates/Test Report](#)

[Special Test Certificate](#)



Maritime application	other
----------------------	-------



[Miscellaneous](#)

other	Railway	Environment
-------	---------	-------------

[Confirmation](#)



[Special Test Certificate](#)

[Environmental Conformations](#)

Further information

Information on the packaging

<https://support.industry.siemens.com/cs/ww/en/view/109813875>

Information for data generation and storage

<https://support.industry.siemens.com/cs/ww/en/view/109995012>

Information- and Downloadcenter (Catalogs, Brochures,...)

<https://www.siemens.com/ic10>

Industry Mall (Online ordering system)

<https://mall.industry.siemens.com/mall/en/en/Catalog/product?mlfb=3RV2928-0B>

Cax online generator

<https://support.automation.siemens.com/WW/CAXorder/default.aspx?lang=en&mlfb=3RV2928-0B>

Service&Support (Manuals, Certificates, Characteristics, FAQs,...)

<https://support.industry.siemens.com/cs/ww/en/ps/3RV2928-0B>

Image database (product images, 2D dimension drawings, 3D models, device circuit diagrams, EPLAN macros, ...)

https://www.automation.siemens.com/bilddb/cax_de.aspx?mlfb=3RV2928-0B&lang=en

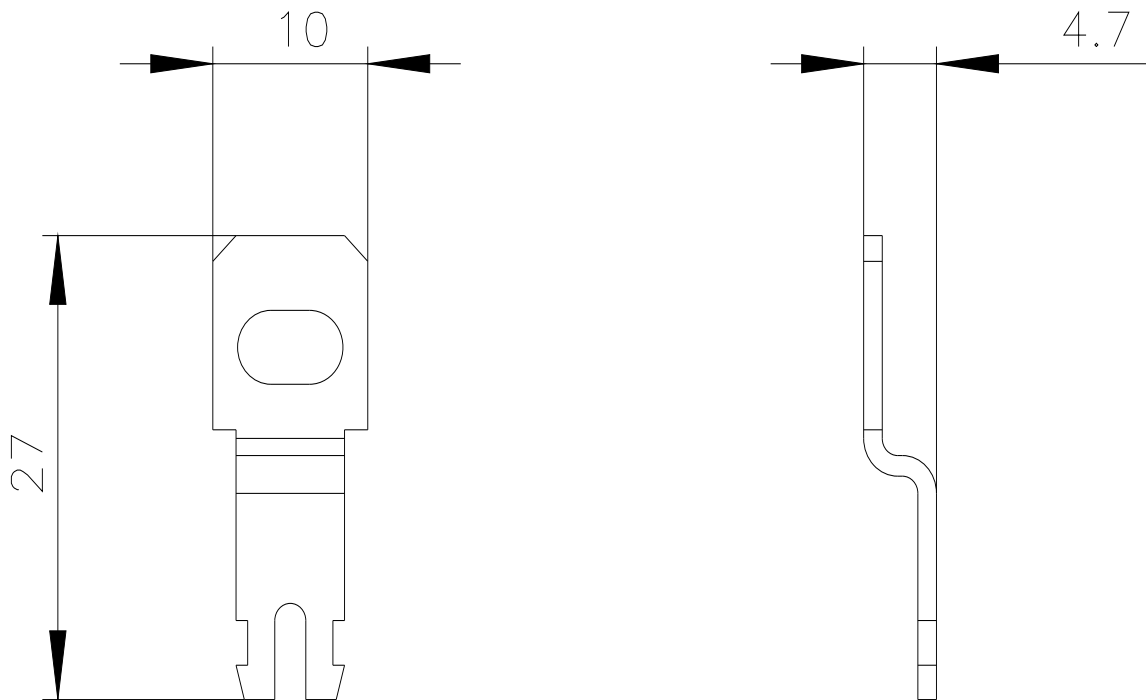

last modified:

4/2/2025 