

cover frame for door cutout 104.6 x 45.65 mm (WxH) accessory for: circuit breaker, 3-pole without TMTU access 3VA12 for loadside mounted residual current module RCD520 250 3-pole 3VA9213-0RL20 RCD820 160 3-pole 3VA9123-0RL30 RCD820 250 3-pole 3VA9223-0RL30

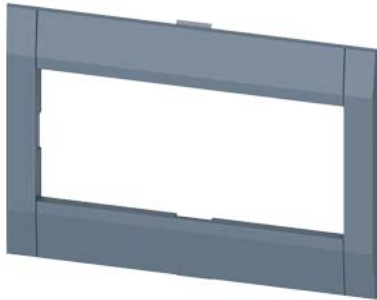

Model	
product brand name	SENTRON
product designation	cover frame for door cutout
accessories	cover frame for door cutout

General technical data	
Net Weight	44 g

Certificates		
General Product Approval	EMV	Test Certificates



EG-Konf.



[Miscellaneous](#)



RCM

[Type Test Certificates/Test Report](#)

Maritime application	other	Environment	
----------------------	-------	-------------	--



LRS

[Confirmation](#)

[Miscellaneous](#)

[Environmental Confirmations](#)

[Environmental Confirmations](#)

Further information

Information on the packaging

<https://support.industry.siemens.com/cs/ww/en/view/109813875>

Information for data generation and storage

<https://support.industry.siemens.com/cs/ww/en/view/109995012>

Information- and Downloadcenter (Catalogs, Brochures,...)

<https://www.siemens.com/lowvoltage/catalogs>

Industry Mall (Online ordering system)

<https://mall.industry.siemens.com/mall/en/en/Catalog/product?mlfb=3VA9253-0SB10>

Service&Support (Manuals, Certificates, Characteristics, FAQs,...)

<https://support.industry.siemens.com/cs/ww/en/ps/3VA9253-0SB10>

Image database (product images, 2D dimension drawings, 3D models, device circuit diagrams, ...)

https://www.automation.siemens.com/bilddb/cax_en.aspx?mlfb=3VA9253-0SB10

CAX-Online-Generator

<https://www.siemens.com/cax>

Tender specifications

<https://www.siemens.com/specifications>

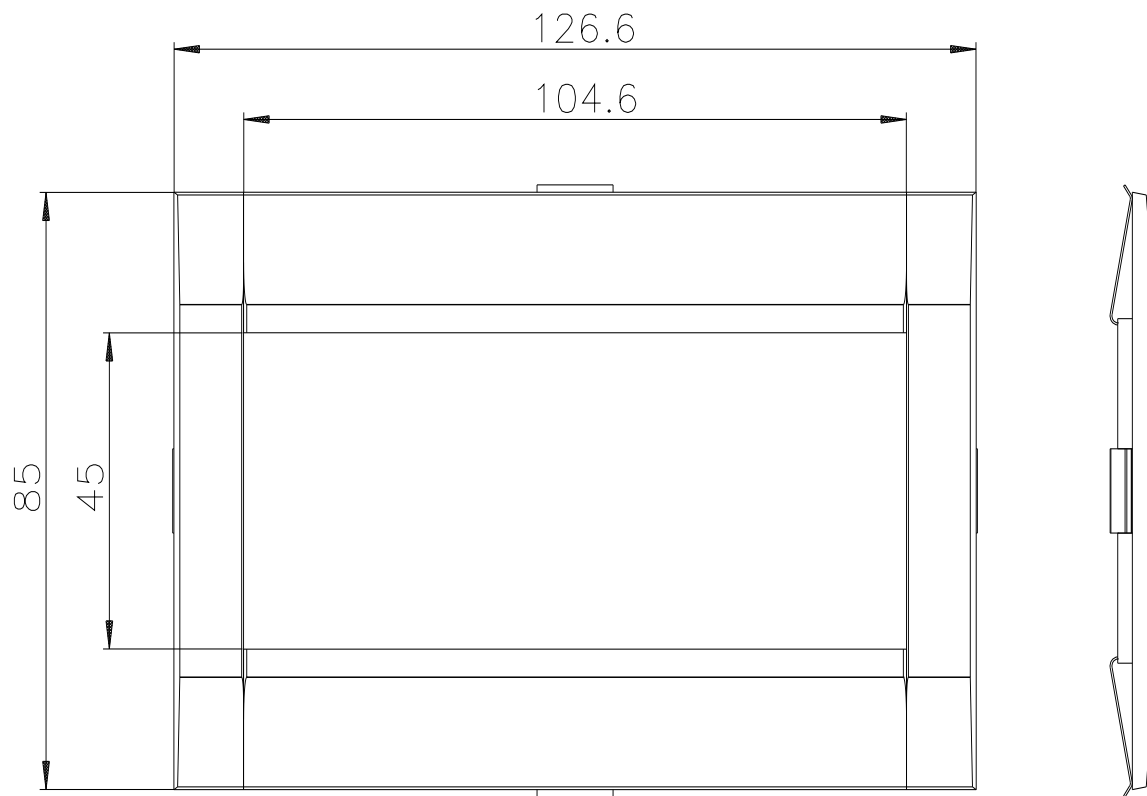

last modified:

4/3/2025 

