

cover frame for door cutout 139.6 x 45.65 mm (WxH) accessory for: circuit breaker, 4-pole without TMTU access 3VA12 for loadside mounted residual current module RCD520 250 4-pole 3VA9214-0RL20 RCD820 160 4-pole 3VA9124-0RL30 RCD820 250 4-pole 3VA9224-0RL30 RCD820B 160 4-pole 3VA9124-0RL40 RCD820B 250 4-pole 3VA9224-0RL40

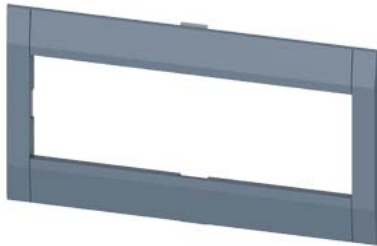

Model		
product brand name	SENTRON	
product designation	cover frame for door cutout	
accessories	cover frame for door cutout	
General technical data		
Net Weight	48 g	
Certificates		
General Product Approval	EMV	Test Certificates



[Miscellaneous](#)



[Type Test Certificates/Test Report](#)

Maritime application	other	Environment		
	Confirmation	Miscellaneous	Environmental Confirmations	Environmental Confirmations

Further information

- Information on the packaging <https://support.industry.siemens.com/cs/ww/en/view/109813875>
- Information for data generation and storage <https://support.industry.siemens.com/cs/ww/en/view/109995012>
- Information- and Downloadcenter (Catalogs, Brochures,...) <https://www.siemens.com/lowvoltage/catalogs>
- Industry Mall (Online ordering system) <https://mall.industry.siemens.com/mall/en/en/Catalog/product?mlfb=3VA9254-0SB10>
- Service&Support (Manuals, Certificates, Characteristics, FAQs,...) <https://support.industry.siemens.com/cs/ww/en/ps/3VA9254-0SB10>
- Image database (product images, 2D dimension drawings, 3D models, device circuit diagrams, ...) https://www.automation.siemens.com/bilddb/cax_en.aspx?mlfb=3VA9254-0SB10
- CAx-Online-Generator <https://www.siemens.com/cax>
- Tender specifications <https://www.siemens.com/specifications>

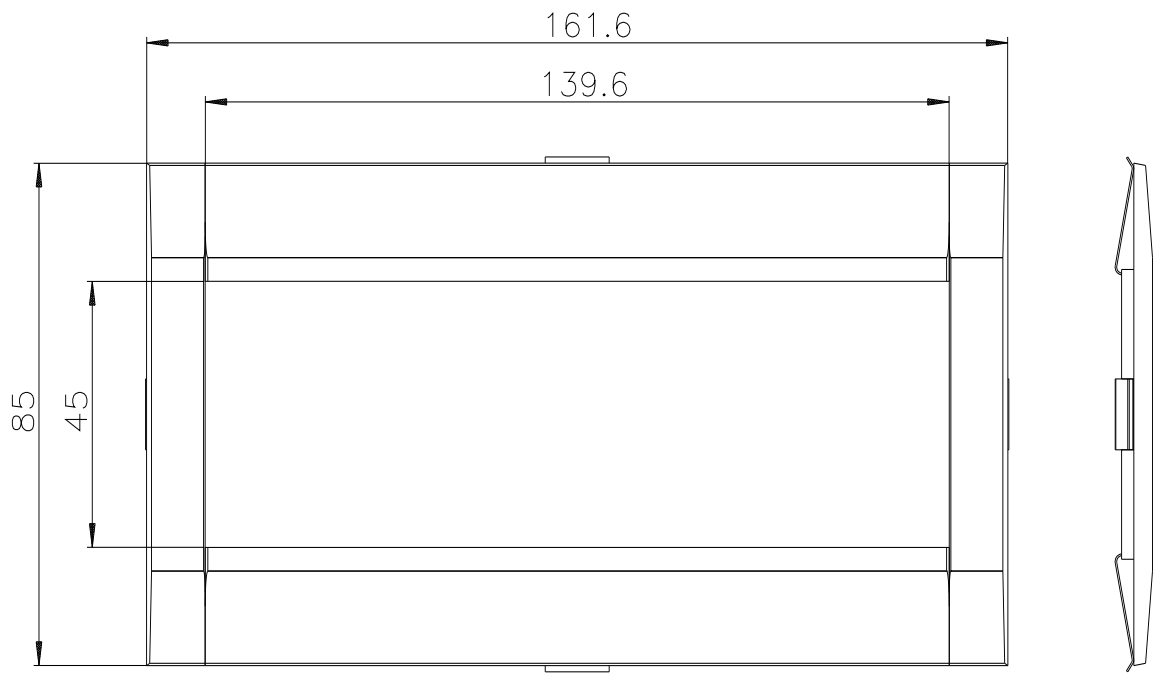

last modified:

4/3/2025 

