

cover frame for door cutout 183.6 x 122.3 mm (WxH) accessory for: circuit breaker, 4-pole with ETU access 3VA63/64

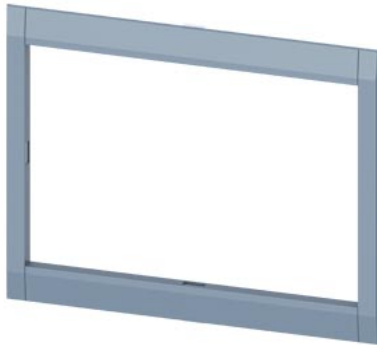

Model	
product brand name	SETRON
product designation	masking frame
accessories	masking frame
General technical data	
Net Weight	64 g
Certificates	
General Product Approval	EMV



[Confirmation](#)

[Miscellaneous](#)



Test Certificates	Maritime application	other	Environment		
<a href="#">Type Test Certificates/Test Report</a>		<a href="#">Confirmation</a>	<a href="#">Miscellaneous</a>	<a href="#">Environmental Confirmations</a>	<a href="#">Environmental Confirmations</a>

**Further information**

- Information on the packaging <https://support.industry.siemens.com/cs/ww/en/view/109813875>
- Information for data generation and storage <https://support.industry.siemens.com/cs/ww/en/view/109995012>
- Information- and Downloadcenter (Catalogs, Brochures,...) <https://www.siemens.com/lowvoltage/catalogs>
- Industry Mall (Online ordering system) <https://mall.industry.siemens.com/mall/en/en/Catalog/product?mlfb=3VA9344-0SB20>
- Service&Support (Manuals, Certificates, Characteristics, FAQs,...) <https://support.industry.siemens.com/cs/ww/en/ps/3VA9344-0SB20>
- Image database (product images, 2D dimension drawings, 3D models, device circuit diagrams, ...) [https://www.automation.siemens.com/bilddb/cax\\_en.aspx?mlfb=3VA9344-0SB20](https://www.automation.siemens.com/bilddb/cax_en.aspx?mlfb=3VA9344-0SB20)
- CAX-Online-Generator <https://www.siemens.com/cax>
- Tender specifications <https://www.siemens.com/specifications>

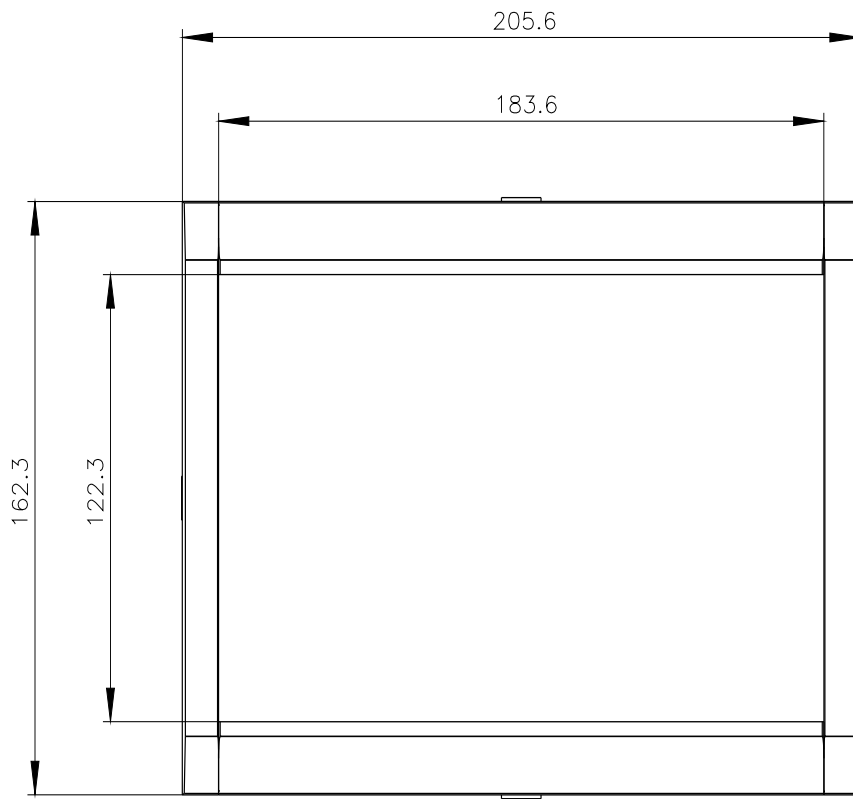

last modified:

4/3/2025 

