



Accessory Circuit breaker 3WA, Flange main connection top or bottom, for frame size 2 - 3200 A for circuit breaker in withdrawable design, 1 piece

Model		
product brand name	SENTRON	
product designation	Flange connection	
design of the product	flange connection for withdrawable circuit breakers	
General technical data		
size of the circuit-breaker	2	
switching capacity class of the circuit breaker	S, M, H, E, D	
Net Weight	1.5 kg	
Approvals Certificates		
General Product Approval	EMV	Test Certificates

[Confirmation](#)



[Miscellaneous](#)

other

[Confirmation](#)



Further information

- Information on the packaging
<https://support.industry.siemens.com/cs/ww/en/view/109813875>
- Information for data generation and storage
<https://support.industry.siemens.com/cs/ww/en/view/109995012>
- Information- and Downloadcenter (Catalogs, Brochures,...)
<https://www.siemens.com/lowvoltage/catalogs>
- Industry Mall (Online ordering system)
<https://mall.industry.siemens.com/mall/en/en/Catalog/product?mlfb=3WA9111-0AW23>
- Service&Support (Manuals, Certificates, Characteristics, FAQs,...)
<https://support.industry.siemens.com/cs/ww/en/ps/3WA9111-0AW23>
- Image database (product images, 2D dimension drawings, 3D models, device circuit diagrams, ...)
https://www.automation.siemens.com/bilddb/cax_en.aspx?mlfb=3WA9111-0AW23
- CAX-Online-Generator
<https://www.siemens.com/cax>
- Tender specifications
<https://www.siemens.com/specifications>

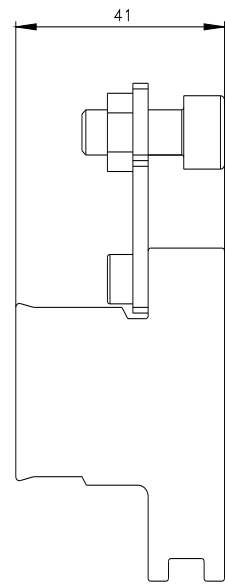
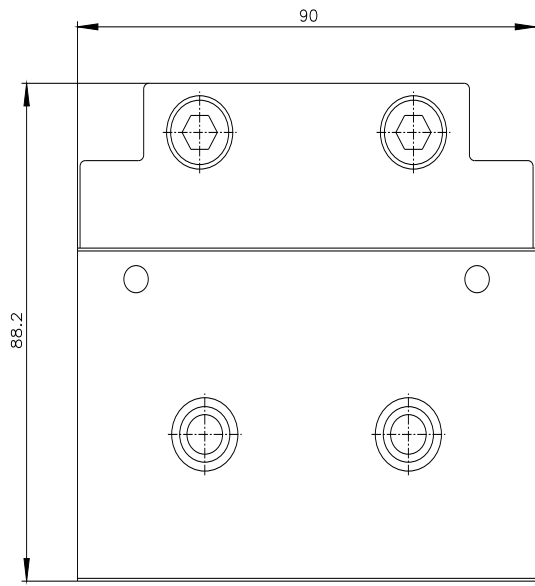

last modified:

4/13/2025 

