

Accessory Circuit breaker 3WA, Grounding connection between guide frame a circuit breaker. Contacting module for circuit breaker, frame size 2 3 poles not for breaking capacity C and frame size 2, 4000A



Model	
product brand name	SETRON
product designation	Grounding connection
design of the product	grounding connection between the guide frame and the circuit breaker

General technical data	
number of poles	3
size of the circuit-breaker	2
switching capacity class of the circuit breaker	S, M, H, E, D
Net Weight	1.555 kg

Approvals Certificates		
General Product Approval	EMV	Test Certificates

[Confirmation](#)



[Miscellaneous](#)

Test Certificates	Maritime application	other	Dangerous goods
-------------------	----------------------	-------	-----------------

[Special Test Certificate](#)



[Confirmation](#)



[Dangerous goods information](#)

### Further information

Information on the packaging

<https://support.industry.siemens.com/cs/ww/en/view/109813875>

Information for data generation and storage

<https://support.industry.siemens.com/cs/ww/en/view/109995012>

Information- and Downloadcenter (Catalogs, Brochures,...)

<https://www.siemens.com/lowvoltage/catalogs>

Industry Mall (Online ordering system)

<https://mall.industry.siemens.com/mall/en/en/Catalog/product?mlfb=3WA9111-0BG12>

Service&Support (Manuals, Certificates, Characteristics, FAQs,...)

<https://support.industry.siemens.com/cs/ww/en/ps/3WA9111-0BG12>

Image database (product images, 2D dimension drawings, 3D models, device circuit diagrams, ...)

[https://www.automation.siemens.com/bilddb/cax\\_en.aspx?mlfb=3WA9111-0BG12](https://www.automation.siemens.com/bilddb/cax_en.aspx?mlfb=3WA9111-0BG12)

CAX-Online-Generator

<https://www.siemens.com/cax>

Tender specifications

<https://www.siemens.com/specifications>

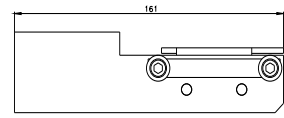
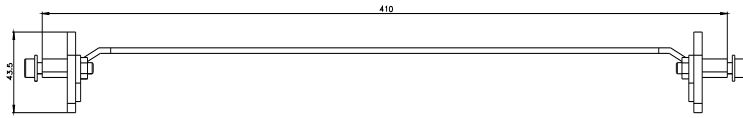

---

last modified:

4/13/2025 

