





Accessory circuit breaker 3WA, Option Plug LSIG GFx 250 A Basic protective function LT, ST, INST and GF, Rated current 250 A (Ground fault protection with extended setting range)



Model	
product brand name	SETRON
product designation	function module
design of the product	function module LSIG GFx 250 A
Net Weight	6 g

Approvals Certificates

General Product Approval	EMV	Test Certificates
Confirmation   <small>EG-Konf.</small>	  <small>RCM</small>	Miscellaneous

Test Certificates	Maritime application	other
Special Test Certificate Type Test Certificates/Test Report	 <small>LRS</small>	 Confirmation

Further information

- Information on the packaging
<https://support.industry.siemens.com/cs/ww/en/view/109813875>
- Information for data generation and storage
<https://support.industry.siemens.com/cs/ww/en/view/109995012>
- Information- and Downloadcenter (Catalogs, Brochures,...)
<https://www.siemens.com/lowvoltage/catalogs>
- Industry Mall (Online ordering system)
<https://mall.industry.siemens.com/mall/en/en/Catalog/product?mlfb=3WA9111-0EX02>
- Service&Support (Manuals, Certificates, Characteristics, FAQs,...)
<https://support.industry.siemens.com/cs/ww/en/ps/3WA9111-0EX02>
- Image database (product images, 2D dimension drawings, 3D models, device circuit diagrams, ...)
https://www.automation.siemens.com/bilddb/cax_en.aspx?mlfb=3WA9111-0EX02
- CAx-Online-Generator
<https://www.siemens.com/cax>
- Tender specifications
<https://www.siemens.com/specifications>

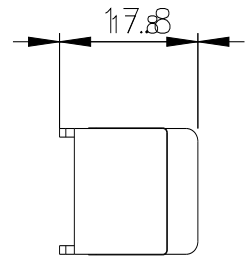
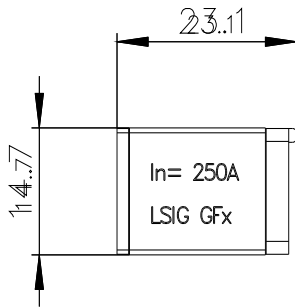

last modified:

4/13/2025 

