





Accessory circuit breaker 3WA, Option Plug LSIG GFx 1250 A Basic protective function LT, ST, INST and GF, Rated current 1250 A (Ground fault protection with extended setting range)



Model	
product brand name	SENTRON
product designation	function module
design of the product	function module LSIG GFx 1250 A
Net Weight	6 g

Approvals Certificates

General Product Approval	EMV	Test Certificates
  		Miscellaneous Special Test Certificate

Test Certificates	Maritime application	other
Type Test Certificates/Test Report		 Confirmation

Further information

- Information on the packaging <https://support.industry.siemens.com/cs/ww/en/view/109813875>
- Information for data generation and storage <https://support.industry.siemens.com/cs/ww/en/view/109995012>
- Information- and Downloadcenter (Catalogs, Brochures,...) <https://www.siemens.com/lowvoltage/catalogs>
- Industry Mall (Online ordering system) <https://mall.industry.siemens.com/mall/en/en/Catalog/product?mlfb=3WA9111-0EX12>
- Service&Support (Manuals, Certificates, Characteristics, FAQs,...) <https://support.industry.siemens.com/cs/ww/en/ps/3WA9111-0EX12>
- Image database (product images, 2D dimension drawings, 3D models, device circuit diagrams, ...) https://www.automation.siemens.com/bilddb/cax_en.aspx?mlfb=3WA9111-0EX12
- CAx-Online-Generator <https://www.siemens.com/cax>
- Tender specifications <https://www.siemens.com/specifications>

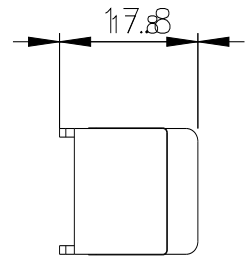
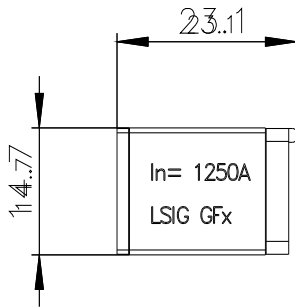

last modified:

4/13/2025 

