







Accessory circuit breaker 3WA, Option Plug LSIG GFx 1600 A Basic protective function LT, ST, INST and GF, Rated current 1600 A (Ground fault protection with extended setting range)



Model	
product brand name	SETRON
product designation	function module
design of the product	function module LSIG GFx 1600 A
Net Weight	300 g

### Approvals Certificates

General Product Approval	EMV	Test Certificates
 EG-Konf.		
		<a href="#">Miscellaneous</a>
		<a href="#">Special Test Certificate</a>

Test Certificates	Maritime application	other
<a href="#">Type Test Certificates/Test Report</a>		<a href="#">Confirmation</a>
		

### Further information

- Information on the packaging  
<https://support.industry.siemens.com/cs/ww/en/view/109813875>
- Information for data generation and storage  
<https://support.industry.siemens.com/cs/ww/en/view/109995012>
- Information- and Downloadcenter (Catalogs, Brochures,...)  
<https://www.siemens.com/lowvoltage/catalogs>
- Industry Mall (Online ordering system)  
<https://mall.industry.siemens.com/mall/en/en/Catalog/product?mlfb=3WA9111-0EX16>
- Service&Support (Manuals, Certificates, Characteristics, FAQs,...)  
<https://support.industry.siemens.com/cs/ww/en/ps/3WA9111-0EX16>
- Image database (product images, 2D dimension drawings, 3D models, device circuit diagrams, ...)  
[https://www.automation.siemens.com/bilddb/cax\\_en.aspx?mlfb=3WA9111-0EX16](https://www.automation.siemens.com/bilddb/cax_en.aspx?mlfb=3WA9111-0EX16)
- CAx-Online-Generator  
<https://www.siemens.com/cax>
- Tender specifications  
<https://www.siemens.com/specifications>

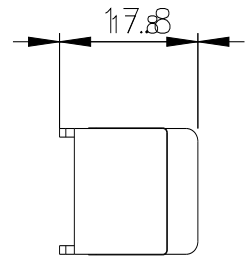
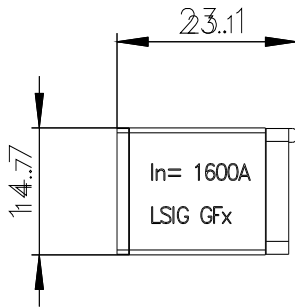

---

last modified:

4/13/2025 

