









Front Connectors (bottom) for circuit breakers fixed mounted, Frame Size 2, for 3WA2 breaking capacity class S / H / E, In = 3000A, for 3WA3 breaking capacity class N / S / M / H / E, In = 2500A, 1 pice (incl. hardware)

| Model  |   |  |  |
|--|---|--|--|
| product brand name   | SENTRON   |  |  |
| Net Weight   | 9.313 kg  |  |  |
| Approvals Certificates   |   |  |  |
| General Product Approval   | EMV   | Test Certificates  |  |
| <br><br><small>EG-Konf.</small> | <a href="#">Confirmation</a>  |  | <br><small>RCM</small>         |
| <a href="#">Special Test Certificate</a>   |   |  |  |
| Test Certificates  | Maritime application  | other  | Dangerous goods  |
| <a href="#">Miscellaneous</a>  | <br><small>LRS</small> | <a href="#">Confirmation</a>   | <br><small>产品合格 QC PASS</small> |
| <a href="#">Dangerous goods information</a>  |   |  |  |

| Further information   |
|---|
| <b>Information on the packaging</b><br><a href="https://support.industry.siemens.com/cs/ww/en/view/109813875">https://support.industry.siemens.com/cs/ww/en/view/109813875</a>  |
| <b>Information for data generation and storage</b><br><a href="https://support.industry.siemens.com/cs/ww/en/view/109995012">https://support.industry.siemens.com/cs/ww/en/view/109995012</a>   |
| <b>Information- and Downloadcenter (Catalogs, Brochures,...)</b><br><a href="https://www.siemens.com/lowvoltage/catalogs">https://www.siemens.com/lowvoltage/catalogs</a>   |
| <b>Industry Mall (Online ordering system)</b><br><a href="https://mall.industry.siemens.com/mall/en/en/Catalog/product?mlfb=3WA9111-1AG23">https://mall.industry.siemens.com/mall/en/en/Catalog/product?mlfb=3WA9111-1AG23</a>  |
| <b>Service&amp;Support (Manuals, Certificates, Characteristics, FAQs,...)</b><br><a href="https://support.industry.siemens.com/cs/ww/en/ps/3WA9111-1AG23">https://support.industry.siemens.com/cs/ww/en/ps/3WA9111-1AG23</a>  |
| <b>Image database (product images, 2D dimension drawings, 3D models, device circuit diagrams, ...)</b><br><a href="https://www.automation.siemens.com/bilddb/cax_en.aspx?mlfb=3WA9111-1AG23">https://www.automation.siemens.com/bilddb/cax_en.aspx?mlfb=3WA9111-1AG23</a> |
| <b>CAX-Online-Generator</b><br><a href="https://www.siemens.com/cax">https://www.siemens.com/cax</a>  |
| <b>Tender specifications</b><br><a href="https://www.siemens.com/specifications">https://www.siemens.com/specifications</a>   |

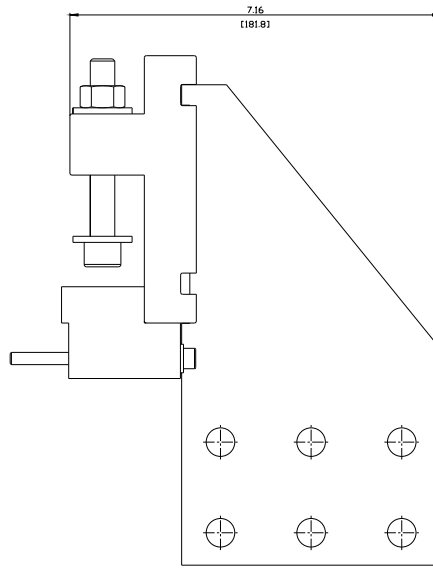
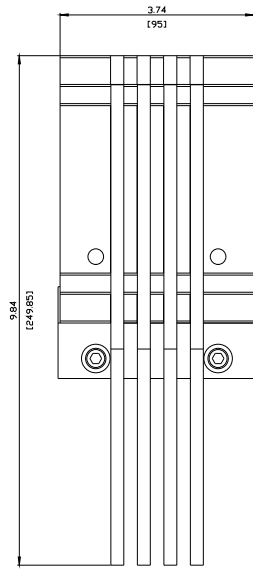

last modified:

10/18/2025 

