





removable terminal block 2-pole, screw terminals up to maximal 2 x 1.5 mm² or 1 x 2.5 mm², for SIRIUS devices in industrial DIN-rail enclosure , without inscription

product brand name	SIRIUS
product category	Removable terminals
product designation	Terminal for control circuit/2-pole
design of the product	Screw terminal/up to 2 x 1.5 mm ² or 1 x 2.5 mm ²
product type designation	3ZY1

General technical data	
Substance Prohibittance (Date)	03/01/2017
Net Weight	0.009 kg
type of connectable conductor cross-sections	<ul style="list-style-type: none"> solid 1x (0.5 ... 2.5 mm²), 2x (0.5 ... 1.5 mm²) finely stranded with core end processing 1x (0.5 ... 2.5 mm²), 2x (0.5 ... 1.0 mm²) for AWG cables solid 1x (20 ... 14), 2x (20 ... 16)
width	7.5 mm

Approvals Certificates

General Product Approval	Test Certificates	Maritime application
   	Type Test Certificates/Test Report	

Maritime application	other	Railway	Environment
 		Confirmation	Confirmation
		Confirmation	Environmental Confirmations

Further information

- Information on the packaging <https://support.industry.siemens.com/cs/ww/en/view/109813875>
- Information for data generation and storage <https://support.industry.siemens.com/cs/ww/en/view/109995012>
- Information- and Downloadcenter (Catalogs, Brochures,...) <https://www.siemens.com/ic10>
- Industry Mall (Online ordering system) <https://mall.industry.siemens.com/mall/en/en/Catalog/product?mlfb=3ZY1121-1BA00>
- Cax online generator <https://support.automation.siemens.com/WW/CAXorder/default.aspx?lang=en&mlfb=3ZY1121-1BA00>
- Service&Support (Manuals, Certificates, Characteristics, FAQs,...) <https://support.industry.siemens.com/cs/ww/en/ps/3ZY1121-1BA00>
- Image database (product images, 2D dimension drawings, 3D models, device circuit diagrams, EPLAN macros, ...)

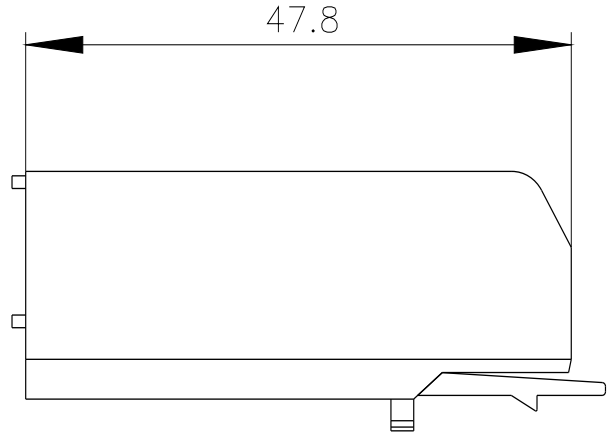
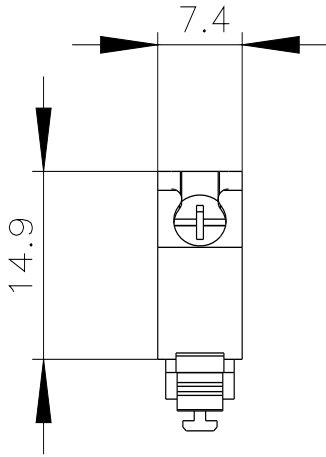

last modified:

4/1/2025 