



current transformer 600/1 A, 5 VA, Cl. 1.0

| Model  |                                   |
|--|-----------------------------------|
| product brand name                                   | SENTRON                           |
| product designation                                  | Current transformer               |
| design of the product                                | Bushing-type current transformers |
| product quality calibrated                           | No                                |
| size of the current transformer                      | 3                                 |
| operating apparent power rated value                 | 5 VA                              |
| operating voltage                                    | 0.72 kV                           |
| insulation voltage rated value                       | 3 kV                              |
| designation of overcurrent limiting factor           | FS 5                              |
| operational current rated value maximum              | 720 A                             |
| current  |                                   |
| • at input rated value                               | 600 A                             |
| • at output rated value                              | 1 A                               |
| accuracy class of the current transformer            | class 1                           |
| value range of the operating frequency               | 50/60 Hz                          |
| Protection class                                     |                                   |
| protection class IP                                  | IP20                              |
| suitability for use for outside use                  | No                                |
| suitability for use for interior use                 | Yes                               |
| product feature touch protection                     | Yes                               |
| Connections  |                                   |
| type of electrical connection at output              | screw-type terminals              |
| Mechanical Design                                    |                                   |
| height   | 98 mm                             |
| height of the opening                                | 21 mm                             |
| width  | 82.5 mm                           |
| width of the push-through bus bar                    |                                   |
| • at 1 bus bar maximum                               | 51 mm                             |
| • in case of 2 bus bars maximum                      | 41 mm                             |
| depth  | 77 mm                             |
| fastening method                                     | screw fixing                      |
| diameter of inlet opening                            | 36 mm                             |
| outer diameter of the push-through conductor maximum | 36 mm                             |
| Net Weight   | 596 g                             |
| Environmental conditions                             |                                   |
| ambient temperature during operation                 |                                   |
| • minimum  | -30 °C                            |
| • maximum  | 55 °C                             |

#### ambient temperature during storage

- minimum
- maximum

-30 °C  
70 °C

#### Approvals Certificates

General Product Approval

other



[Confirmation](#)



[Confirmation](#)

#### Environment

[Environmental Confirmations](#)

#### Further information

##### Information on the packaging

<https://support.industry.siemens.com/cs/ww/en/view/109813875>

##### Information for data generation and storage

<https://support.industry.siemens.com/cs/ww/en/view/109995012>

##### Information- and Downloadcenter (Catalogs, Brochures,...)

<https://www.siemens.com/lowvoltage/catalogs>

##### Industry Mall (Online ordering system)

<https://mall.industry.siemens.com/mall/en/en/Catalog/product?mlfb=4NC5327-0CE21>

##### Service&Support (Manuals, Certificates, Characteristics, FAQs,...)

<https://support.industry.siemens.com/cs/ww/en/ps/4NC5327-0CE21>

##### Image database (product images, 2D dimension drawings, 3D models, device circuit diagrams, ...)

[https://www.automation.siemens.com/bilddb/cax\\_en.aspx?mlfb=4NC5327-0CE21](https://www.automation.siemens.com/bilddb/cax_en.aspx?mlfb=4NC5327-0CE21)

##### CAX-Online-Generator

<https://www.siemens.com/cax>

##### Tender specifications

<https://www.siemens.com/specifications>

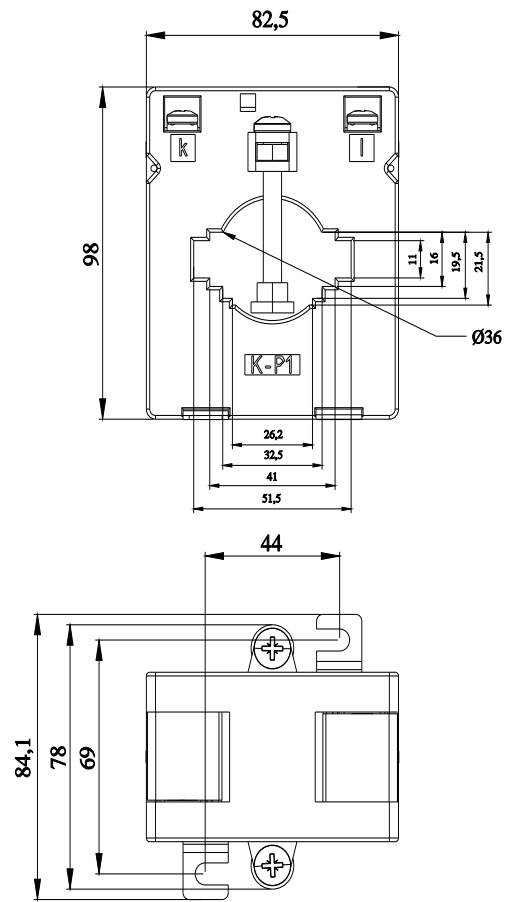

last modified:

4/15/2025 

